

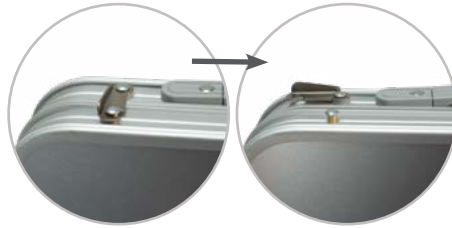

1



2 Unlatch the locking hooks.



3 Unfold the table, so the surface is flat.



4 Latch the side hooks to secure the tabletop together.

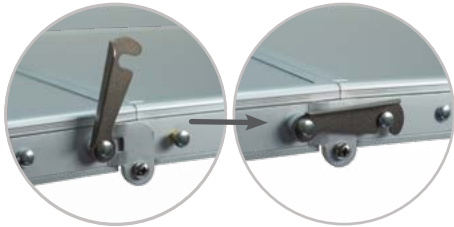

5 Lift the legs vertically.



6 Open each leg fully until the hinges are all straight.



7 Engage the hinge into the locked position.

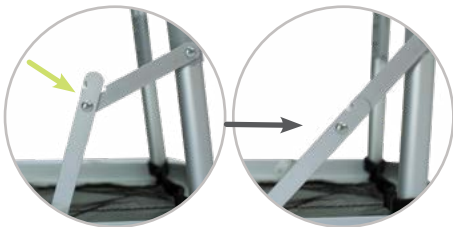

8 Pull the legs out and twist clockwise to tighten.



9 Choose desired height.



10 Ready to use.



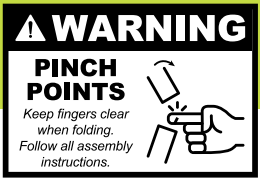

1 Turn the table upside down.



2 Twist the legs anti-clockwise to loosen and push the legs back in.



3



4 Disengage the hinge into the close position.

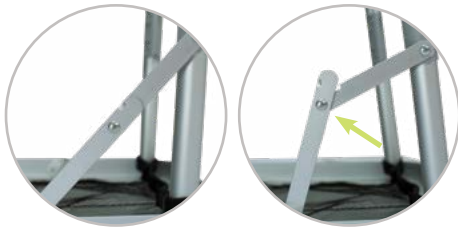

5 Fold the legs down. **Note:** ensure all legs are flat against the surface.

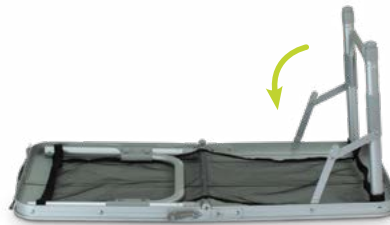

6 Unlatch the side hooks to release the tabletop.



7 Fold the table.



8 Latch the locking hooks.

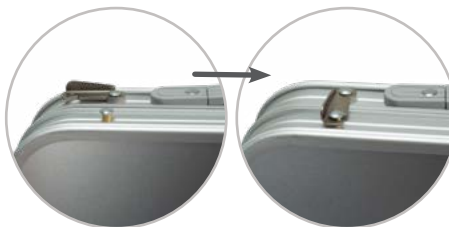

2 Year Limited Warranty

We take pride in the quality and design of every ZEMPIRE table or cupboard, that's why our TABLES & CUPBOARDS come with a strong guarantee designed to protect you as our valued customer. ZEMPIRE will repair or replace this product, should it fail due to faulty materials or manufacture for a period of 2 years from the date of purchase.

For a full explanation of what is covered under this warranty please refer to our website www.zempire.co.nz/warranty.

Care & Safety information:

- Do not stand on your table.
- Do not use near open flame.
- Clean thoroughly after each use. Wash by hand with warm water and a soft towel or sponge.
- Do not use harsh cleaning chemicals.
- Leave the table to dry out completely before putting it away.
- Do not keep the table in direct sunlight or leave it in the rain.
- Store away from chemicals and moisture.